

THP Series



SLAB SIDE RUBBER COMPRESSION MOLDING MACHINE

旁板型橡膠硫化機系列

 **TungYu**

FORMING INNOVATION

東毓深耕成型技術 持續擴展應用領域

Tung Yu specializes in crafting cutting-edge hydraulic machines, from rubber compression to injection molding, revolutionizing industries across 75+ nations. Join us in shaping the future of technology and experiencing the Tung Yu difference!

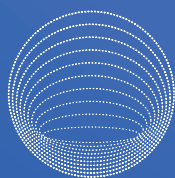

TYC



TIP

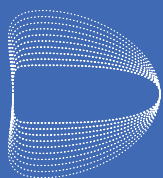

THP

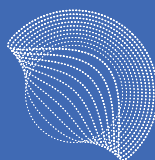

Tire

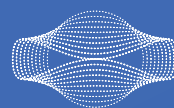

Heavy Duty
Composites

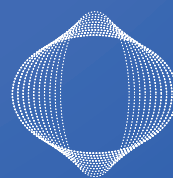

YCP

Tung Yu - Tailor-Made Solutions Provider

TungYu, certified to ISO 9001 and ISO 14064 standards and CE compliant, has been a trusted expert in hydraulic machinery since 1983. Tung Yu manufactures a wide assortment of products, from 5 tons hydraulic press to 15,600 tons conveyor belt production line and we offer a comprehensive One-Stop Shopping service for customers. Our product line includes: Compression Molding Machines, Rubber and Silicone (Solid/Liquid) Injection Molding Machine, Conveyor Belt Vulcanizing Machines, Tire Molding Machines, Retreading and Solid Tire Molding Machines.

東毓油壓機械股份有限公司，自1983創立以來，秉持著董事長楊楨彬先生之「穩健踏實、永續經營」經營理念，以「誠信」立足市場。『Tung Yu』品牌行銷全球七十餘國。承製能力範圍廣闊，鎖模力由5噸小型油壓沖床至15,600噸的輸送帶硫化機，均能承製。主要機械產品線：熱壓成型機、橡矽膠(固/液態)射出成型機、輸送帶硫化機、輪胎硫化機、翻新胎硫化機以及各式油壓機械，產品應用領域跨足各大產業。未來發展以創新為目標，深耕「力量與熱量載具」之核心技術，成為成型技術的領先者，為客戶創造最大價值。



總公司 Headquarters



南投市南崗工業區 Nantou City

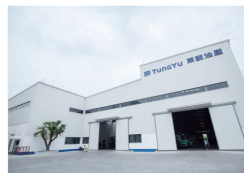

中國寧波 Ningbo China

日本東京 日東株式會社
Japan - Tokyo Branch NITTO Co., Ltd.
印度孟買 孟買辦事處
India - India Branch, Tung Yu
(India) Liaison Office

■ THP Series Machine Ranges THP系列機型

03	Standard Range 標準機型	11	Auxiliary Machine 輔助設備
06	THP Model Guide and Specifications THP型式說明與規格表	13	Oil Seal & Rubber Parts Trimming Machine 油封及橡膠件整修機系列
07	Custom-made Machine 客製化機型	18	Global Sales Network 全球銷售網絡

THP-V-100-2RT-S-PCD

Rubber Oil Seal Vulcanization Molding Machine (Slab Side Type) 真空油封橡膠硫化機

Mechanical features at a glance

- Vacuum cover design - reduces curing time and increases production efficiency.
- High speed vacuum system - eliminates air inside cured rubber to have products with zero defect quality.
- Mold in/out, bumping and stripping all completed in one cycle automatically, every stage is free adjustable.
- 真空罩裝置—硫化時間大幅縮短，生產效率提升。
- 高速真空系統—原料流動性佳、消除成品內包氣泡，成品零缺點。
- 進退模、排氣、離型全自動循環，每階段可自由控制。

Products 製造成品

- Oil seals
- Bearing seals
- Automotive parts
- 工業用油封
- 機械軸封
- 汽機車用油封



Features 特寫說明

- Plate turn over at 60° , for easy parts removal.
- 翻板角度達60° ，方便成品取出。

THP-V-150-3RT-S-PCD (CE)

Rubber Oil Seal Vulcanization Molding Machine (Slab Side Type)

真空油封橡膠硫化機

Mechanical features at a glance

- Equipped with top, lower and middle plate for various molds design to knock out products.
- Full caging with light curtain for safety operation.
- Mold in/out, bumping and stripping all completed in one cycle automatically, every stage is free adjustable.
- Simplicity in mechanism for easy maintenance.
- 搭配上拍、下拍及中拍可運用於各種模具設計拍出成品。
- 全包式圍網設計，搭配光柵裝置，確保操作安全。
- 進退模、排氣、離型全自動循環，每階段可自由控制。
- 機構設計精簡，維修保養更方便。



2-Layer Mold (2RT) Opening Way 2層模具(2RT)離型方式示意圖

Upper Clapper Plate Ejection Device
上拍板，頂出裝置

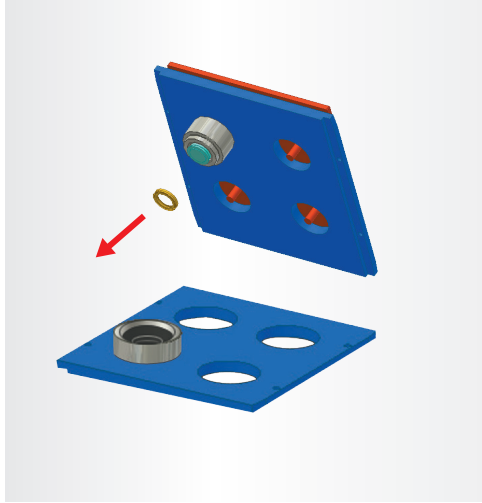

Lower Clapper Plate Ejection Device
下拍板，頂出裝置

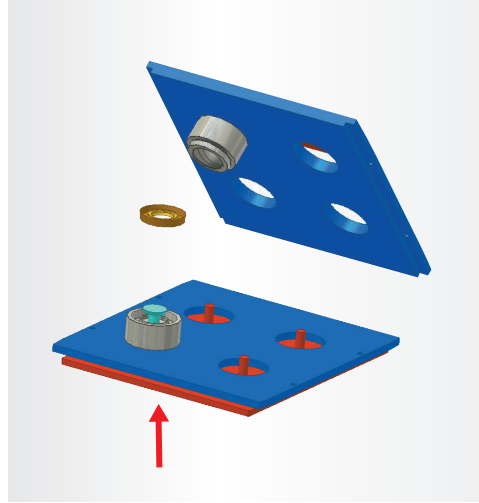

3-Layer Mold (3RT) Opening Way 3層模具(3RT)離型方式示意圖

Upper Plate Ejection Device
上拍板 頂出裝置

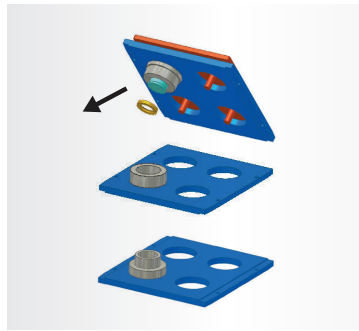

Middle Plate Left Side Ejection Device
中拍板左移 頂出裝置

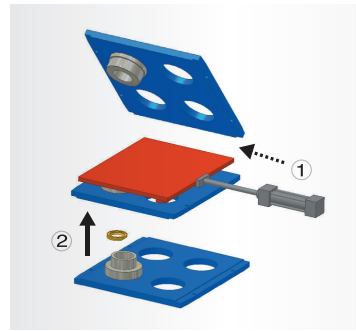

1. Middle plate moves to left side.
2. Middle bolster plate lifts upwards and eject by middle plate.
1. 中拍板左移
2. 中模架板上升，利用中拍板頂出成品

Lower Plate Ejection Device
下拍板 頂出裝置

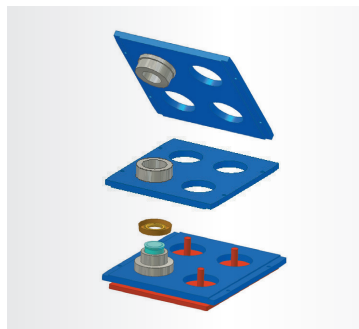

Middle Mold with Lower Plate Ejection Device
中模下拍板 頂出方式

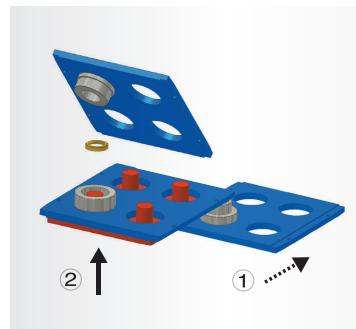

1. Lower mold move backwards.
2. Lower plate lift up and eject.
1. 下模後退
2. 下拍板上升，頂出中模成品

THP Model Guide 型式說明

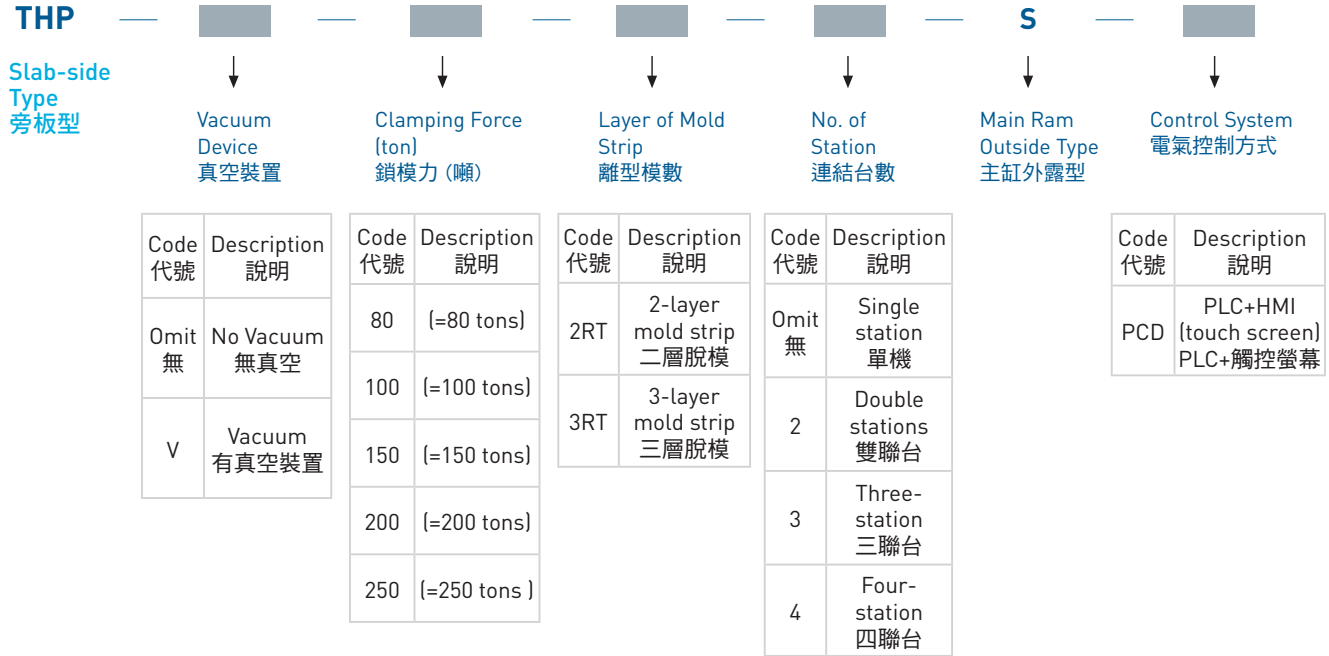

THP Series Technical Specifications 機器規格表

Machine Type	機型	THP-V-80	THP-V-100	THP-V-150	THP-V-200	THP-V-250	
Clamping Force	鎖模力 ton	80	100	150	200	250	
Piston Diameter	活塞直徑 mm	§ 225	§ 250	§ 300	§ 355	§ 400	
Heating Platen Size	熱盤尺寸 mm	250x300	350x400	450x480	450x480	570x610	
Bolster Plate Size	模架板尺寸 mm	290x320	390x420	500x520	500x520	620x620	
Daylight	最大開檔 mm	200					
Stroke	最大行程 mm	140					
Vacuum Accessories	真空方式	Vacuum Cover Type 真空罩式					
Power Consumption	使用功率 kW	4.8	8.76	8.76	8.76	18.2	
Turnover Degree	翻轉角度	60° (2RT)			45° (2RT)		
		45° (3RT)					
Dimension (mm)	外觀尺寸	2RT	1165 x 1976 x 1987	1145 x 2080 x 2000	2362 x 1365 x 1982	1681 x 2487 x 1960	1032 x 3026 x 2085
		3RT	1534 x 1970 x 1870	1510 x 2262 x 1926	2362 x 1365 x 1982	1981 x 2487 x 1960	1718 x 3139 x 2073

THP-V-250-3RT-S-PCD (CE)

Rubber Oil Seal Vulcanization Molding Machine (Slab Side Type)

真空油封橡膠硫化機

Mechanical features at a glance

- Upper plate turnover degree is adjustable for easily clean.
- Low working height for ergonomic engineering.
- Open working area with safety light curtain protection for easily process monitor.
- Suitable for 2 or 3 layer molds.
- 可調式翻板角度，方便模具卸載。
- 低工作高度，符合人因工程。
- 開放式工作區域，搭配安全光柵保護，方便流程監控。
- 適用2層及3層模具。



THP-V-250-3RT-S-PCD (CE)

Rubber Oil Seal Vulcanization Molding Machine (Slab Side Type)

真空油封橡膠硫化機

Mechanical features at a glance

- Equipped with top, lower, and middle plates, supporting various mold designs for efficient product knockout.
- Full-enclosure caging with integrated safety light curtains ensures maximum operational security.
- Fully automated cycles—including mold in/out, degassing (bumping), and stripping—with each stage independently adjustable.
- Streamlined mechanical design for high reliability and simplified maintenance.
- Modular design ready for integration with automatic trimming machines to achieve high-efficiency, end-to-end production lines.
- 搭配上拍、下拍及中拍機構，可靈活運用於多樣化模具設計，確保成品順利脫模。
- 採用全包式安全圍網設計並搭配光柵裝置，嚴格守護操作安全。
- 進退模、排氣及離型採全自動循環動作，且每一階段參數均可根據製程需求自由調整。
- 結構設計精簡精確，大幅提升機台穩定性並簡化日常維護作業。
- 模組化設計可選配搭配自動修邊機，實現從成型到後加工的整線自動化生產需求。

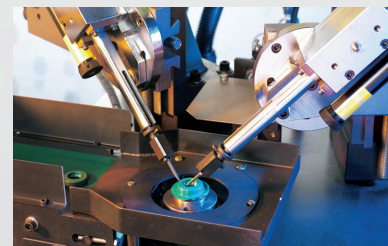

THP-V-200-2RT-S-PCD

Features of Automated Skeleton Oil Seal Production Line 自動化骨架油封生產線

Mechanical features at a glance

- Seamlessly integrates raw material handling, rubber vulcanization, and finished product extraction for continuous, unmanned operation.
- Synchronized vibration feeders and high-speed 3-axis robotic arms ensure precise material alignment and consistent, high-efficiency output.
- Eliminates high-temperature operational risks while supporting multi-machine resource sharing to maximize equipment utilization and reduce labor costs.
- 透過振動盤精準送料與三軸聯動機械手快速抓取，確保物料排列一致性與生產高效率。
- 完美整合原料抓取、橡膠硫化成型至成品取出，實現全線無人化自動運行。
- 徹底規避高溫作業風險，並支援多機台共享自動化機構，最大化設備利用率並大幅降低人力成本。



Optional Accessories 選購配備



Full Color Touch Screen
大尺寸彩色人機

Ease of operation, parameter setup and monitoring.

方便人員操作，參數設定與監控。

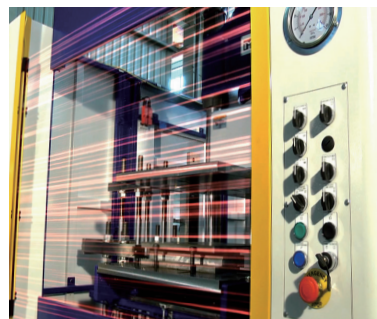

Safety Sensor & Light Curtain
安全電眼

Combined with PLC control system, ensures full protection of operators.

搭配PLC程式控制，確保操作人員安全。

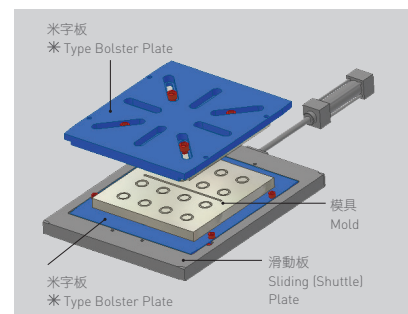

*** Type Bolster Plate**
米字型模架板

By fixing “*” type bolster plate, THP series machines can be used for O-rings, gaskets and various rubber parts.

THP機型加裝米字型模架板(米字板)後，即可使用板模生產O型環、墊片及其他橡膠產品。

THP-14X4-A-S-PCD-UP(CE)

Thermoplastics Stamping Machine

大型熱塑複材沖壓成型機

Mechanical features at a glance

- Applied to thermoplastics stamping.
- Top-mounted drive mechanism effectively reduces working height and eliminates pit construction costs.
- 應用於熱塑性材料沖壓成型
- 採上置式機構設計，有效降低工作高度並減少地坑施工費用。

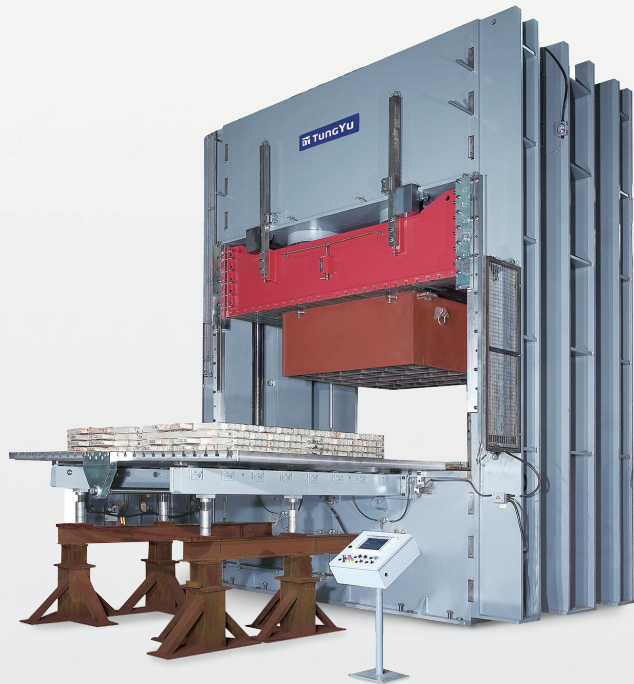

THP-4500-A-S-PCD-2L

Large-scale Customized Slab Side Type Molding Machine

大型客製化旁板成型機

Mechanical features at a glance

- Optimized for heavy-duty anti-vibration components.
- High-stiffness side plate construction minimizes frame deformation.
- Dual-sided shuttle tables support flexible single or double-deck production.
- 針對重型減震零件進行優化。
- 高剛性旁板結構，將機架變形量降至最低。
- 雙邊滑出式工作台，可彈性選擇單層或雙層生產。



TR-V-240-PCD

Precision Rubber Slicer

精密橡膠切片機

Close Loop and Smart E-weight Data feed back 閉環迴路+飛切系統

- Simplify process decrease adjusting time.
- Equipped with smart E-weight data feedback system (close loop), enable to adjust cutter speed automatically.
- Weight precision within $\pm 1\%$ (95% finished product).
- With clean window design for easily cleaning and changing rubber compounds.
- Equipped with vacuum system to get rid of air inside rubber compounds.
- Cutter with advanced balance design that runs stably and silently.
- 縮短人員調整時間。
- 本機使用量測系統搭配油路與重量回饋控制，自動依實際需求調整切刀速度。
- 重量精度: $\pm 1\%$ 內 (95%成品)。
- 掃除窗設計易於清理更換膠料。
- 內建真空系統，減少膠料氣泡。
- 特殊刀柄配重設計，運轉安靜穩定，增加切刀使用壽命。



TR-250-PCD

Precision Rubber Slicer

精密橡膠切片機

Mechanical features at a glance

- with customizable die heads for diverse Smart Digital Control: Advanced HMI with parameter memory for rapid, high-efficiency mold changes.
- Precision & Versatility: Silent, balanced cutter design shaping needs.
- 智能數位控制：先進觸控系統結合模組記憶功能，實現快速換模，大幅提升生產效率。
- 精密與多樣化：靜音平衡刀頭搭配可調式模頭，滿足多種成品形狀切片需求。

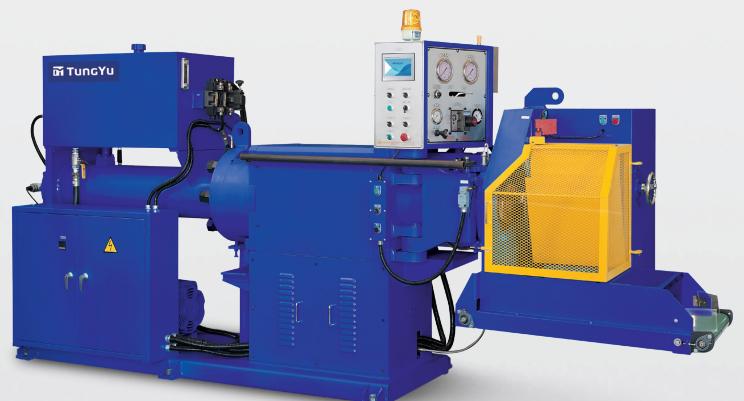

Process 製造循環圖

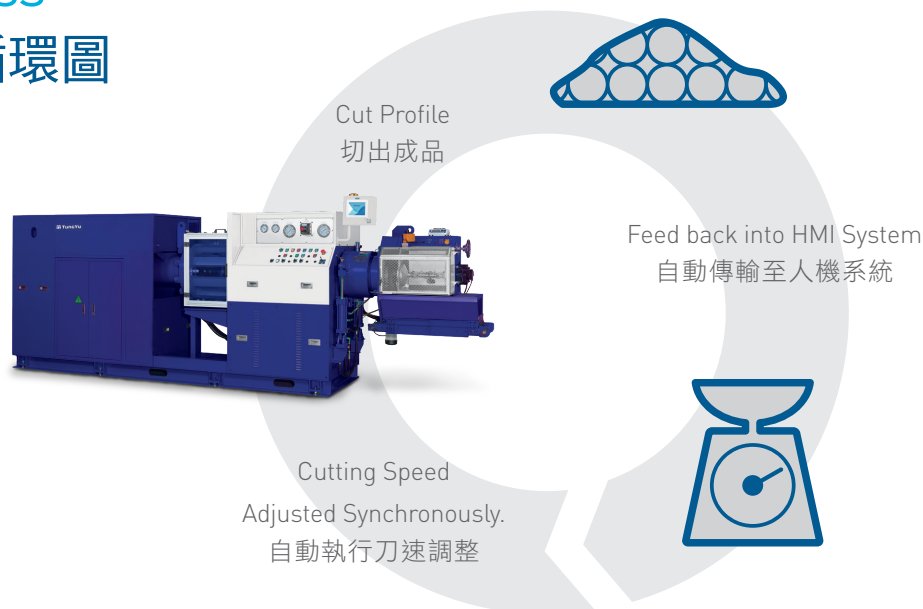

TR Series Precision Rubber Slicer 精密橡膠切片機

Machine Type	機型		TR-V-240-PCD	TR-250-PCD
Volume of Material barrel (Max. Batch Capacity)	料筒置料 (一次最大可裝膠料容) L		40	45 60(Option) (選配)
Horsepower	使用馬力		15HPx4P	15HPx4P
Cutter Motor	切刀馬達		Servo Motor 伺服馬達	Inverter Motor 變頻馬達
Vacuum Pump	真空泵浦	kW	0.55	Option 選配
Rubber Clean Window	膠料清除窗		Standard 標準配置	Option 選配
Finished Product Size (O.D.)	成品尺寸(外徑)	mm	5-80	5-80 80-160 (Option)(選配)
			0.3-300	0.3-300(以上為選配)
Weight of Finished Product	成品重量	g	The data will be limited by different cutter speed, die mold, extruding pressure and rubber compound hardness. 需搭配切刀速度、模具、擠出壓力調整及膠料硬度限制	
Precision of Finished Product	成品精度		95% Finished Product within $\pm 1\%$ 95%成品在 $\pm 1\%$	95% Finished Product within $\pm 1.5\%$ 95%成品在 $\pm 1.5\%$
Quantity of Cutter	切刀數量		Single-cutter 單刀型	
Cutter Speed	最高刀速	rpm	400	250
Speed Changing of Cutter	刀速變速方式		Free-stage Adjustable 可無段調整	
Temp. of Material Barrel	料筒溫度	$^{\circ}\text{C}$	Max. 90°C	
Temp. Precision of Material Barrel	料筒溫度精度	$^{\circ}\text{C}$	$\pm 5^{\circ}\text{C}$	
Heat Transfer	傳熱方式		Water 水	
Weight of Final Remains	最後殘料重量	kg	約10~15(Approx.)	
Feed Capacity Control Way	成品料重控制方式		Feed Back System 飛切系統	Auto Setting and Stop 自動設定
Digital Touch Screen Controller	PCD數位式觸控系統		Standard 標準配置	
Dimensions	外觀尺寸	mm	(L)5128 X (W)1080 X (H)1911	(L)4230 X (W)1310 X (H)1980 (L)4862 X (W)1310 X (H)1980
Net Weight	機台淨重	kg	5040	2550 3900

NR Series

Vacuum Type Rubber Parts Trimming Machine

真空式橡膠件整修機

This machine is used for cutting the flash of the circle rubber parts.
本真空式油封整修機用以切削圓形橡膠件的毛邊。

Features 特點

- Manual feed and auto trim.
- The vacuum generator will suck the oil seal through the mold during the cutting period to get the best cutting precision.
- There are many cutting mode for the user to choose. To cut the inner and outer flash simultaneously.
- The user can choose the Inverter to adjust the spindle speed.
- The light curtain and fence will protect the operator's safety and keep the working environment clean. (CE type)
- 手動送料自動修邊。
- 利用真空特性配合模具吸住加工物件以切割毛邊，以得到最好切割品質。
- 多種切割模式可供選擇。內外毛邊切除一次完成。
- 使用者可選擇使用變頻器以調整主軸轉速。
- 光幕保護操作者安全，圍籬維護環境乾淨。(CE型式)



NRC Series

Collet Chuck Type Trimming Machine

夾頭式油封整修機

This machine is used for cutting the flash of the metal case oil seal.
適用於鐵殼型油封的內外毛邊的切削。

Features 特點

- Manual feed and auto trim.
- The #25 collet chuck grabs the oil seal to cut the flash.
- There are many cutting mode for the user to choose. To cut the inner and outer flash simultaneously.
- Right cutting angle is 0° - 90° .
- 手動送料自動修邊。
- 利用#25型彈性夾頭夾住加工物件以切割毛邊。
- 多種切割模式可供選擇，內外毛邊切除一次完成。
- 右切割角度為 0° - 90° 。



ATAS Series

Oil Seal Trimming and Spring Loading Machine

油封修邊及裝彈簧機

This machine is suitable to cut the flash and load the spring with high volume oil seals in the production line.
本機器適用於生產線上多量少樣油封的切削毛邊及裝填彈簧。

Features 特點

- The vacuum generator/gripper feeds the oil seal to precisely fit it onto the cutting mold and then cut the flash.
- Magnet rotator/Vibrating tray feeds the spring to appropriate location.
- The tooling is pulled fast by the air cylinder to combine the oil seal with the spring.
- It will check if the spring is being correctly loaded by metal probe and sort out defects.
- 吸盤/夾爪將油封精確的置放於主軸之上然後切割毛邊。
- 磁盤/震動盤將彈簧送至正確掛簧位置。
- 氣缸快速的推動治具來將油封與彈簧組合。
- 以探針確認彈簧是否正確裝填並將不良品分離。



RRT

Ring Cone Type Trimming Machine

輪轉式油封修邊機

Features 特點

- Auto feed and auto trim.
- Cutting the outer and inner flash at a time.
- One person operates 2 or 3 machines at the same time.
- 自動送料自動修邊。
- 內外徑一次切割完成。
- 操作人員可一次操作 2-3台機器。

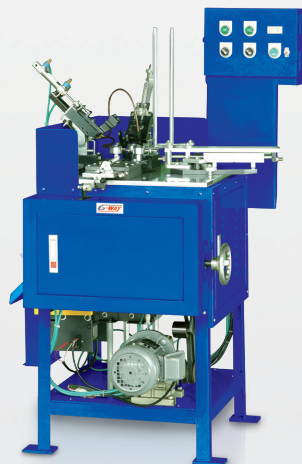

KS-1

Knife Grinding Machine

磨刀機

Features 特點

- The water cooling system will cool down the grinding temperature to avoid the overheating of the blade.
- The gear handle and double slides help the operator to orientate the blade precisely and easily.
- 採水冷式冷卻刀片以避免刀片過熱。
- 齒輪把手及雙十字滑座協助使用者精確定位。



TEST-H-PCD / TEST-S-PCD

Twin-shaft Oil Seal Gyration Testing Machine

雙軸油封迴轉試驗機

Mechanical features at a glance

- Suitable for oil seal high pressure condition and abrasion testing.
- Testing shaft can gyrate clockwise / anti-clockwise.
- Attached with temperature recorder to record details of temperature, speed and gyration / start / stop time.
- Fully automatic control and setting (including pressure and temperature).
- 適用於油封高壓、耐磨耗測試。
- 附加溫度計錄器，完整記錄溫度、迴轉速度及迴轉/啟動/停止時間。
- 全自動控制(含壓力、溫度設定及控制裝置)。

Medim Pressure Type 中壓軸轉型



Standard 標準型



※Remarks: 1. TEST-S-PCD with shell gyration type and TEST-H-PCD with shaft gyration type is available.
2. For usage of oil temperature over 150°C, appropriate type of oil should be prepared by buyer.
3. Optional up to 10,000rpm.
4. Pressure setup available for low & middle pressure type.
5. Expect for shell gyration and micro-pressure type, it'll be equipped with safety fence and pressure protection device.

※註：1. 亦有標準殼轉型及中壓軸轉型。
2. 欲使用高於150°C之油溫測試需由客戶自備合適條件之油品。
3. 選配轉速達10,000rpm。
4. 低壓及中壓可設定壓力。
5. 低壓以上之規格搭配防護罩與超壓自動洩壓保護設備，確保操作安全。

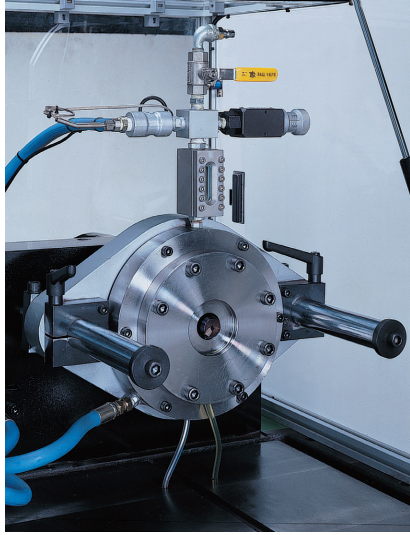

Medim pressure Type
中壓軸轉型

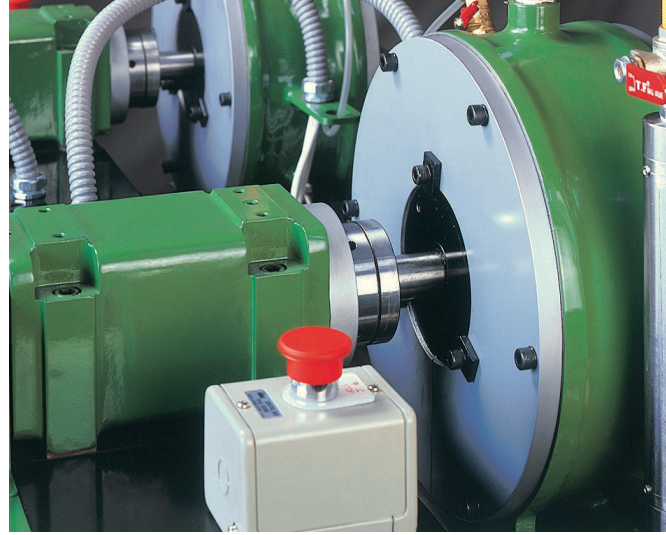

Standard Type
標準型

TEST Series Oil Seal Gyration Testing Machine 油封迴轉試驗機

Machine Type	機型		Shell Gyration 殼轉	Micro-pressure 微壓	Low Pressure 低壓	Medium Pressure 中壓
Testing Pressure Range	可測試壓力範圍	kg/cm ²	MAX: 0.3	MAX: 0.3	0.5~6	5~30
Pressure Adjustment	壓力調整方式			Manual 手動		Proportional 比例式
Spindle Range	可測軸徑範圍	mm	§ 15~ § 120	§ 10~ § 200	§ 10~ § 170	§ 10~ § 80
The Shell /Housing Diameter	最大殼徑		§ 150	§ 250	§ 200	§ 120
Testing Spindle Speed Range	測試軸可調轉速範圍	rpm	200~6000	200~10000	200~6000 (10000選配)	200~6000
Testing Temperature (MAX)	最高使用溫度	°C	120°C			
Inspection of Seal Leaking	洩漏檢測方式		Visual Check 目視	By Oil Mass of Leaking Cup 量杯目視	By Leaking Cup or Auto Detect 量杯或自動檢出	
Setting of Testing Parameter 每一模式可設定之條件						
(1)Testing Time	(1)運轉時間	1H	•	•	•	•
(2)Stop Time	(2)停止時間	1min	•	•	•	•
(3)Testing Speed	(3)轉速設定	rpm	•	•	•	•
(4) Temperature	(4)溫度	°C	•	•	•	•
(5)Testing Pressure	(5)壓力	kg/cm ²				•
(6)Testing Gyration (Clockwise / Counter Clockwise)	(6)轉向(正逆)		•	•	•	•
Cycle Numbers	模式循環數		Max. 9999 Cycles			

※ Max. linear speed: 26,180 mm/sec [RPM synchronized with product dimensions].
 ※ 最大線速：26,180 mm/sec (轉速依產品尺寸彈性配置)

TRD

Seal Shell (Metal Insert)
Rotary Air-dryer
油封鐵殼風乾迴轉機

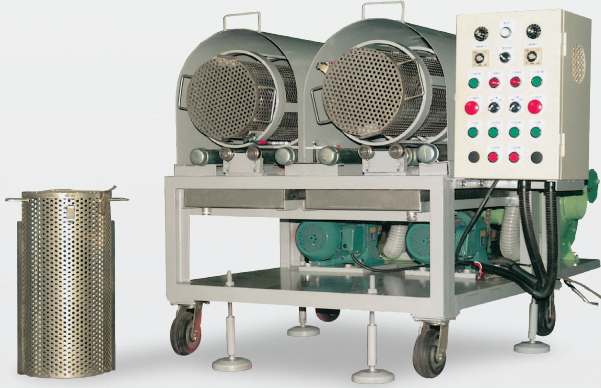

Machine Type 機型			TRD Single 單聯	TRD Double 雙聯
Capacity per time 處理能力	kg/time		20	20x2
Rotary Speed 轉速	rpm		Adjustable 可變式	
Total Power 總用電量	kW		1.2	2.4
Machine Dimension WxLxH 尺寸	mm		850x1450x1150	1270x1450x1150
Machine Weight 重量	kg		150	250

TA

Seal Shell (Metal Insert)
Adhesive Applying Machine
浸藥附著機



Machine Type 機型			TA-30	TA-50
Capacity per time 處理能力	kg/time		30	50
Electrical Power 電熱	kW		7	
Total Power 總用電量	kW		8	
Air Pressure 空氣壓力	kg/cm ²		5-7	
Machine Dimension WxLxH 尺寸	mm		1600x1700x2250	1900x1700x2250
Machine Weight 重量	kg		2500	2800

TS

Automatic Feeding & Cutting Machine
橡膠自動切斷機

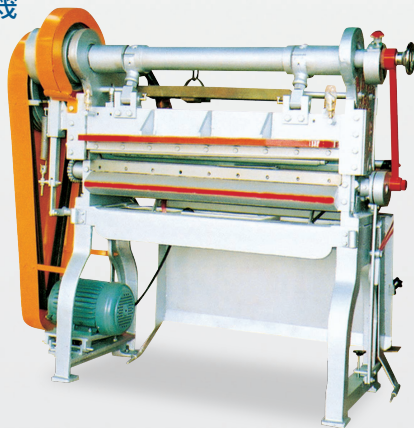

Machine Type 機型			TS-20	TS-25
Blade Width 刀寬度	mm		608	759
Width of Machine 機械寬度	mm		1130	1260
Height of Machine 機械高度	mm		1280	
Cutting Speed 每分鐘切料	times/min		57	
Horse Power 馬力	HP		1	
Width Range 調整切斷寬度	mm		1-95	
Weight 重量	kg		420	460

TD

Rubber Slitting Machine
橡膠分條機

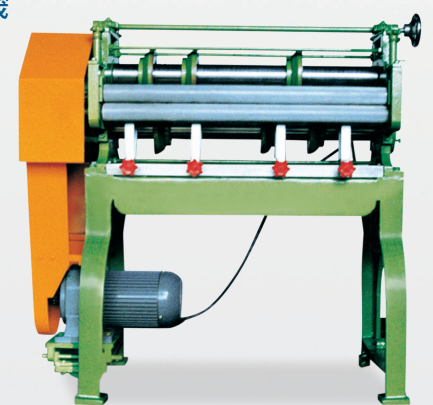

Machine Type 機型			TD-20	TD-25
Blade Width 刀寬度	mm		608	760
Width of Machine 機械寬度	mm		1068	1220
Height of Machine 機械高度	mm		1200	
Cutting Speed 每分鐘切料	mm/min		8200	
Horse Power 馬力	HP		1	
Weight 重量	kg		230	260

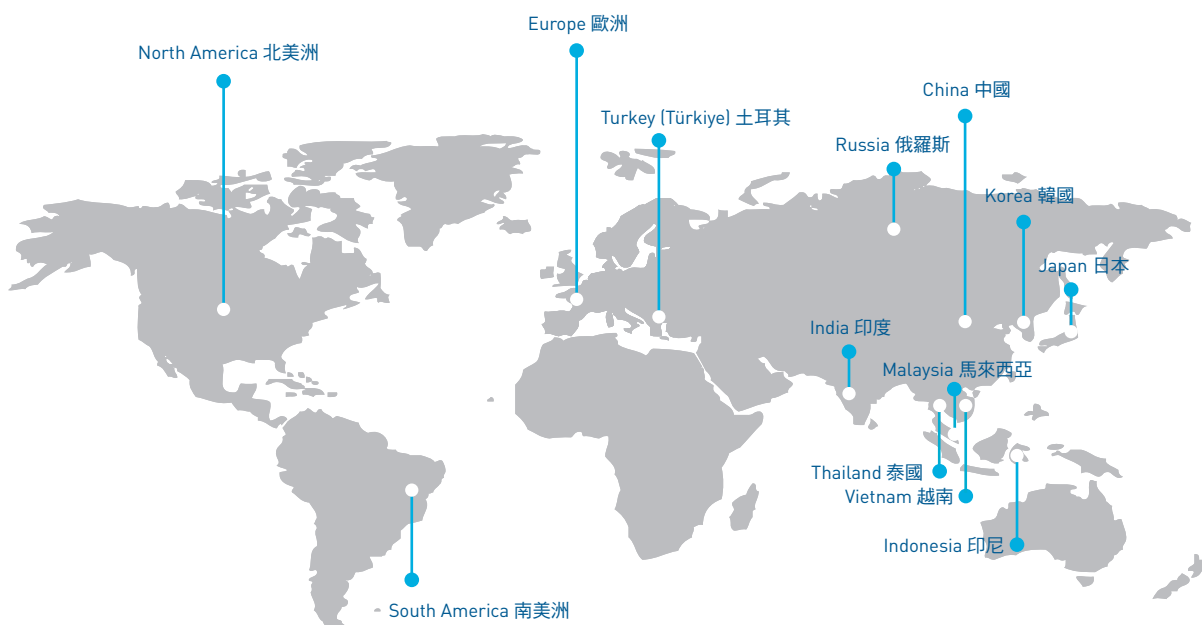

Japan 日本 代理商

株式會社 日東
NITTO Co., Ltd.
341-0012 埼玉縣三郷市半田 1427-1
1427-1 Handa, Misato City, Saitama,
341-0012, Japan
T + 81-48-951-7761 F + 81-48-951-7960
info@kk-nitto.co.jp
www.kk-nitto.co.jp/index.html

India 印度 代理商

Salnik Solutions&Tung Yu (India) Liaison Office
509-510 'A'Wing, 4th Floor, Orchard Mall Rd.,
Royal Palms Estate, 169-Aarey Milk Colony Rd.,
Goregaon (East), Mumbai - 400 065, India
T + 91 22 2877 6547 F + 91 22 2877 3147
tungyu@tungyuindia.com

Europe 歐洲 代理商

Rep International
15, rue du Dauphine 69960 Corbas, France
T + 33 4 72215353 F + 33 4 72512235
commercial@repinjection.com

North America 北美洲 代理商

Rep Corporation
310 Katom Dr, Kodak, TN 37764, United States
T + 1 847 697 721
Service@repcorp.com

Indonesia 印尼 代理商

PT. Asia Talenta Mandiri
CBD@Jababeka Blok F-21, Jl. Niaga Raya Kav.
AA3, Jababeka, Cikarang, Bekasi, Jawa Barat 17530,
Indonesia.
T + 62(0)21 2908 2716 F + 62(0)21 2908 2803
yogisusono@gmail.com

Turkey (Türkiye) 土耳其 代理商

Vizyotek San.Mak.Paz.Bak. Ve Ser.Hiz. San.
Tic.Ltd. Sti.
21.yy Cd. 18.Sk. Zigana Sit. No.4 Bademli
Bursa Türkiye
T + 90 224 5491208 F + 90 224 5491209
vizyotek@vizyotek.com.tr

Korea 韓國 代理商

Jugi Corporation
Room No. 916, 129, Bongeunsa-ro
(Nonhyun-dong Geopyeong Town),
Gangnam-gu, Seoul, 06121 Korea
T + 82 2 5478254 F + 82 2 5488254
info@jugicorp.com

Thailand 泰國 代理商

Ultra - D Tung Yu Machinery Co.,Ltd.
No. 12/653 Moo 12 Bangkaeo Bang phli
Samutprakarn 10540 Thailand
T + 668-1450-3178
derek@ultradtungyu.com

Malaysia 馬來西亞 代理商

Centre West Industrial Supplies Sdn. Bhd.
No. 9, Jalan TSB 8, Taman Industri Sungai
Buloh , 47000 Petaling Jaya Selangor,
Malaysia
T + 60 3 6157 6688 F + 60 3 6157 0651
Mobile + 60 1221 88972
derek@centrewest.com.my

Brasil 巴西 代理商

REP INJETORAS DE BORRACHA LTDA
Rua Amorim Diniz, 60 Sala 01 - Jardim
Jaú03730-040 São Paulo - SP
T + 55 11 9 9965 8661
mcarvalho@repinjection.com

Germany 德國 代理商

REP Deutschland GmbH
Sauergasse 5-7 D-69483
Wald-Michelbach - Deutschland
T + 49 6207 9408 0 F + 49 6207 9408 29

United Kingdom 英國 代理商

Rep Rubber Injection Ltd
T + 44 0759 688 3260
Gary.anderton@repuk.co.uk

Russia 俄羅斯 代理商

Rti-Snab Ltd.
Polzunova st. 3, Tula 300028, Russia
T/F + 7 4872 656367
M + 7 985 7617422
rti-snab@yandex.ru

South Vietnam 南越南 代理商

CÔNG TY TNHH CHIEH KE INT'L VN
杰格國際越南責任有限公司
Ap An My, Xa An Dien, Huyen Ben Cat, Tinh Binh
Duong, Vietnam
T + 84 650 3554128/29/30/31 F + 84 650 3554166
chiehkevn@gmail.com
sales@full-shine.com

Affiliates 關係企業

G-WAY 吉瑞精機

G-WAY Machinery Industrial Co., Ltd
540 南投市永興路12號(南崗工業區)
No. 12, Yongsing Rd., Nan Kung Industrial Zone,
Nantou City 540, Taiwan R.O.C.
T + 886 49 2258239 F + 886 49 2258229
gway@tungyu.com
www.g-way.com.tw



台灣總公司 Headquarters

東毓油壓機械股份有限公司
Tung Yu Hydraulic Machinery Co., Ltd.

540 南投市永興路12號 (南崗工業區)
No. 12, Yongxing Rd., Nangang Industrial Park,
Nantou City, Nantou County 540, Taiwan
T + 886 49 2253588 **F** + 886 49 2252998 **E** tungyu@tungyu.com

中國寧波公司 China Ningbo

東毓(寧波)油壓工業有限公司
Tung Yu (Ningbo) Hydraulic Industries Co., Ltd.

315221 中國浙江省寧波市鎮海區蛟川街道東信路666號
No. 666, Dongxin Road, Jiaochuan Street, Zhenhai District,
Ningbo City, Zhejiang Province, China.
T + 0574-55333028 **F** + 0574-86598057 **E** ningbo@tungyu.com
全國免費服務專線 Free Hot Line 40011-33028